



Christian Architectural Assistance Association

107 S. Baywood Lane
252.756.6065

Greenville, NC 27834
batied@mail.ecu.edu

<http://www.intergate.com/~caaa/>

January 2004

Volume 1/2004

Welcome to Our Readers

As we enter the beginning the 8th year of this ministry, we want to Praise the Lord for His faithfulness and direction. Wonderful and exciting things are happening in this ministry, and as we approach our Lord's return, we are diligent in doing His work on earth.

Project Update

Praise the Lord for the blessing the Lord has bestowed on this ministry. Our project load has expanded with a variety of new projects.

We have completed the preliminary floor plans for a new **Educational Wing** for **Central Baptist Church**, in Syracuse, NY. who is under the leadership of **Pastor Milton Kornegay**. This fine Gothic style Church has been a challenge when designing the addition. We are awaiting approval on the documents before completing the project. Please pray for this church and for our ability to understand all the needs.

We are continuing the development of a **Master Plan** for **Ambassador Baptist College** in Lattimore, NC, under the leadership of **Dr. Ron Comfort**, President and Founder of the college. We have created preliminary designs for the relocation of the **College Library** and **Student Center**, as well as the design for the potential relocation of the **Music Department** to the school gymnasium building. We have also prepared designs for a **new Gymnasium Building** and **School Auditorium**. It is our intent to have the Final Master Plan for review by the end of February.

This growing fundamental Baptist College is expanding to fulfill the needs of their students. Please pray for this ministry and the outstanding staff that have a burden for developing fine men and women to work for the Lord.

We have completed the preliminary floor plan for a Sanctuary Addition to **Sunrise Baptist Church**, in Marian, NC. Under the leadership of **Pastor Darrell Worley**, this growing church has the need

to expand with an **Educational Wing**. We have just completed the preliminary drawings, and are awaiting feedback on the project. The church is working with a local contractor to construct this addition as soon as our documents are complete.

Please pray for **Pastor Darrell Worley** as he has been recently experienced medical problems.

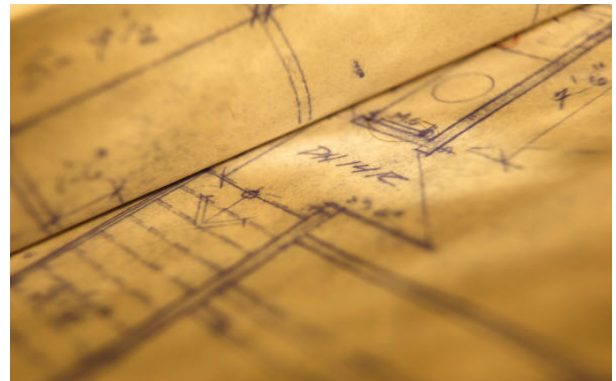

New Projects

Since our last newsletter, the Lord has blessed us with a number of new projects that we are in various stages of development.

We are developing a **Sanctuary and Office Complex Addition** to **Bailey's Grove Baptist Church** in Asheboro, NC. Under the leadership of **Pastor Jon Shook**, this design will incorporate Phase One construction for this growing congregation. Phase Two will provide a needed **Educational Wing** in the coming years. The existing Sanctuary will be used for the Youth Ministry until that time.

By the time you receive this newsletter, we will have traveled to Monroe, NC to meet with **Pastor Tim Cruse** of **Shining Light Baptist Church**. This growing, dynamic ministry has obtained 50+ acres adjacent to their church site that will be used for a **Christian Youth Camp**. We will develop a **Master Plan** for planning purposes of the facility. We will

continue to provide design services for the designs of the specific Camp Buildings.

In Manassas, VA, Pastor **Associate Pastor Russell Anderson** of **Bull Run Baptist Church** is spearheading a new building project. The church recently purchased a former Elementary School Building. They are in the preliminary stages of remodeling the existing spaces for their new church. We have been asked to design a new **Sanctuary Addition** to expand the ministry. Until that structure is constructed, the existing Multipurpose Room will be used as the sanctuary.

We are creating **Fire Exiting drawings** for **Greenville Christian Academy** in Greenville, NC. GCA is a long-time ministry of **People's Baptist Church** under the leadership of **Dr. Max Barton**. The drawings will provide electronic drawings of the various additions of this school that have been misplaced or lost over the past 35 years.

We are continuing to assist **Camp Grace** in Fairmont, NC. Under the leadership of **Bobby and Karen Williams**, this Youth Camp continues to grow and expand. We are developing a three-stage building plan for a new **Camp Meeting Complex** that includes dining areas, a camp kitchen, and various meeting rooms. It is the prayer that Stage One can begin construction in the late Spring 2004.

We recently met with **Pastor David Jackson** and the Building Committee of **Freedom Baptist Church** in Goldsboro, NC. This church has outgrown their existing new structure and is looking to expand with a **Fellowship Wing** and a **Youth Educational Wing**. CAAA will provide consulting services for the church as they negotiate with a local Contractor to construct the additions.

Blessings

We have purchased a new Dell Computer and needed software updates because of the generous **Love Offering** from **Ambassador Baptist College**.

We also want to thank **People's Baptist Church** for their doubled December Support Check. It has been such a blessing to this ministry for their support from the very first month of our work.

Continued monthly support by **Dorado Bible Baptist Church** in Dorado, Puerto Rico, under the leadership of **Pastor Orlando Rivera** is a blessing. We designed their church in 1998, and they have continued to support us since that time.

Michael Simonowich of **SpeedyBlue Printing** in Greenville, NC has been a blessing to this ministry. He provides all of our blueprinting needs free of charge. Without that cost savings, we would not be able to provide many of our current drawings to our church projects.

Your prayers are so important to us. If your ministry is in need of our services or if you are led to financially support the ministry, please contact us.

David L. Batie, NCARB, RA
Christian Architectural Assistance Association
107 S. Baywood Lane
Greenville, NC 27834
252.328.1383 (D) batied@mail.ecu.edu
252.756.6065 (E) 252.328.1165 (FAX)

Christian Architectural Assistance Association
107 S. Baywood Lane
Greenville, NC 27834
252.756.6065
batied@mail.ecu.edu

To: